

SEPTEMBER 2020

COMMUNITY ADVISORY GROUP

MICHAEL BRANDT
DEPUTY LABORATORY DIRECTOR
CHIEF OPERATING OFFICER

AGENDA

COVID-19 AND PSPS UPDATE

Status update
on cases at the
lab

PEOPLE ON SITE PILOT 2b

Our pilot program is
running smoothly,
with 1200 employees
on site.

CONSTRUCTION PROJECTS

Status of ongoing
construction projects
on the Lab site.

COVID RESEARCH AT THE LAB

Lab scientists have been
working on COVID-19
research. Here is a short
video on our efforts.

COVID-19 AND PSPS UPDATE

COVID-19 Cases Reported to the Lab

12

TOTAL CASES REPORTED (Cumulative)

ON-SITE CASES

10

OFF-SITE CASES

2

2

RECENT CASES
REPORTED AS OF SEPTEMBER 11

We are tracking cases at the lab and with our COVID safety protocols, with zero occupational transmissions.

Planning for PSPS

CONNECT
ELECTRICAL SWITCH
TO PG&E
GENERATOR



LOSS MITIGATION STRATEGIES

PG&E collaborations to minimize shutdowns

- Minimize impacts of future outages
- Develop switchstation generators
- Restore or replace facility specific generators
- Improve facility specific system robustness.

POWER OUTAGE WORKING GROUP

- Division-specific power shutdown plans
- Identify critical needs after safe and stable established
- Validating emergency essential personnel and equipment

EMERGENCY MANAGEMENT

- Establish new **outdoor** EOC compliant w/ COVID safety protocols
- Conduct a PSPS exercise in late September (contingent on Lab-wide factors)

PEOPLE ON SITE: PILOT 2b

Methodical Resumption of Activities

BEFORE COMING TO WORK:

- Line Management Authorization
- Training & Health Pledge
- Daily Symptom Check
- Weekly Health Check

WHEN YOU ARRIVE AT YOUR LAB LOCATION:

- Badge-in Required
- Face Covering
- Physical Distance
- Hand Washing

MORE INFO:
covid.lbl.gov

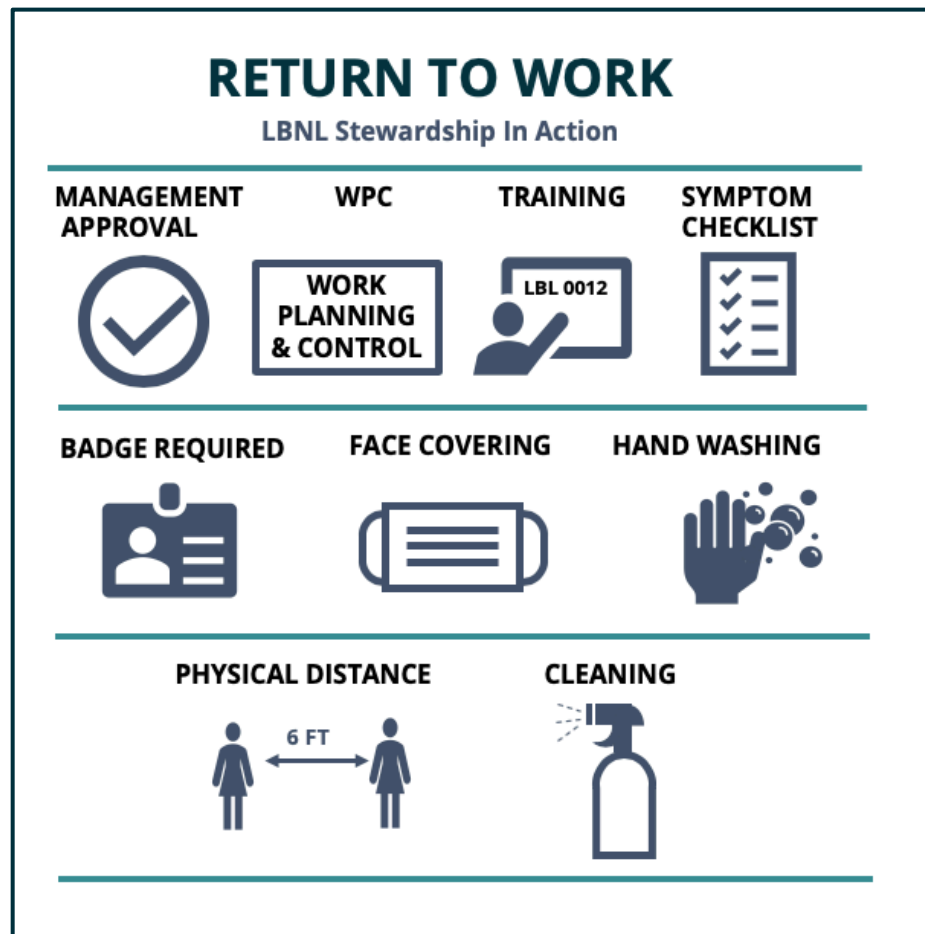

Employee training, a symptoms checklist, work planning and controls help keep our Lab safe.

Methodical Resumption of Activities

Currently in Pilot 2b

- A peak of 1200 workers on Lab sites
- Substantially below the estimate of maximum safe occupancy with COVID controls
- Capacity study of all buildings on Lab sites will be finalized next month
- Developing software tool to more easily schedule personnel with capacity constraints
- Carefully ramp up to maintain COVID controls within capacity limitations

Lab Status as of 9/8/2020

PEOPLE ON SITE

1 SQUARE = 100 PEOPLE



ON SITE PILOT 1 PILOT 2a PILOT 2b
TELEWORK

IN PERSON MEETINGS



TRAVEL



CAFETERIA



SHUTTLE



HEALTH SERVICES



SHIPPING/RECEIVING



GUEST HOUSE



LEGEND



NO ACTIVITY



LIMITED



FULL SERVICES

Our graded pilot approach to returning to full capacity is proving effective.

Pilot Program: Design, Test and Learn

LBNL Return to Work Pilot Series	Peak # of Workers Per Day at Lab Sites	Time Frame
Federal Phase 0		
Safe Standby	200 - 450	April - May
LBNL Pilot 1 - Test COVID-19 Controls	450 - 800	June
Federal Phase 1		
<p>Continue to ENCOURAGE TELEWORK whenever possible and feasible with business operations.</p> <p>If possible, RETURN TO WORK IN PHASES.</p> <p>Close COMMON AREAS where personnel are likely to congregate and interact, or enforce strict social distancing protocols.</p> <p>Minimize NON-ESSENTIAL TRAVEL and adhere to CDC guidelines regarding quarantine following travel.</p> <p>Strongly consider SPECIAL ACCOMMODATIONS for personnel who are members of a VULNERABLE POPULATIONS.</p>	<p>Pilot 2A - (800 - 1000) ~ July 7</p> <p>Pilot 2B - (1000 - 1200) ~ Aug 10</p> <p>Pilot 2C - (Planning Tool Pilot) - (1200 - 1400)</p> <p>Pilot 2D (Planning Tool Pilot) - (1400 - 1600)</p> <p>Pilot 2F (Planning Tool Role Out) - (1600 - 1800)</p> <p>Pilot 2G (Manage to % Density) - (1800 - 2000)</p> <p>Pilot 2F (Manage to Full Denisty) - (2000 -2400)</p>	July - Dec
Federal Phase 2		
<p>Continue to ENCOURAGE TELEWORK whenever possible and feasible with business operations.</p> <p>Close COMMON AREAS where personnel are likely to congregate and interact, or enforce strict social distancing protocols.</p> <p>Strongly consider SPECIAL ACCOMMODATIONS for personnel who are members of a VULNERABLE POPULATIONS</p>	New Normal	FY21 to ?
Federal Phase 3		
Normal Operations	4,500	? **

We are operating in Pilot 2b, with 1200 employees authorized to work onsite.

CONSTRUCTION PROJECTS UPDATE

Operational Excellence: Safety is Job One

B73: QUANTUM



SSM: Seismic Safety Modernization

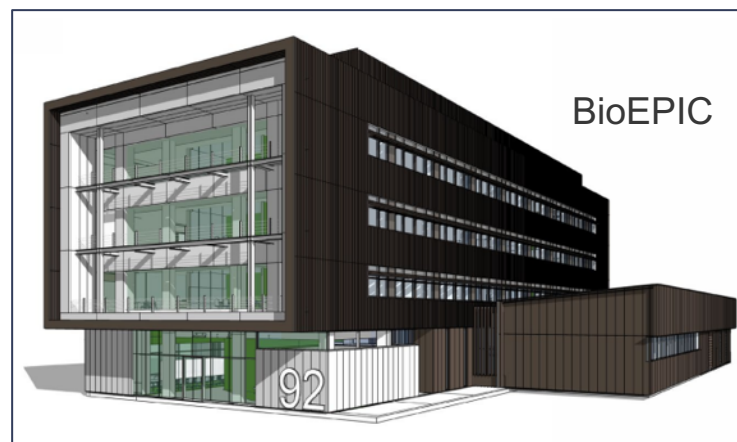
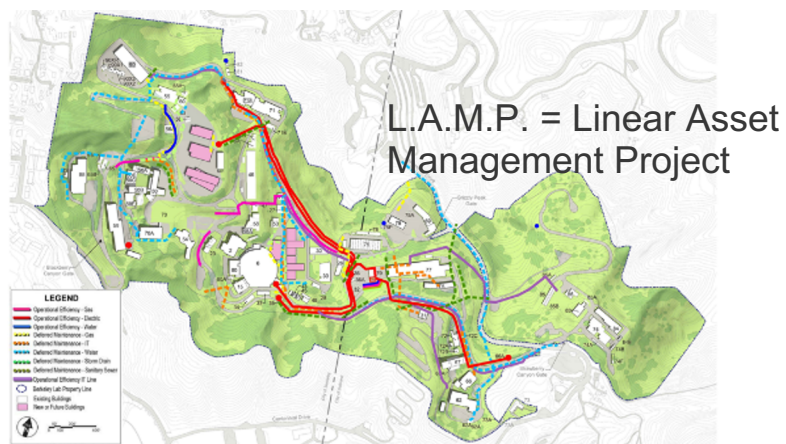

COVID-19 RESEARCH AT THE LAB

COVID-19 Research at the Lab

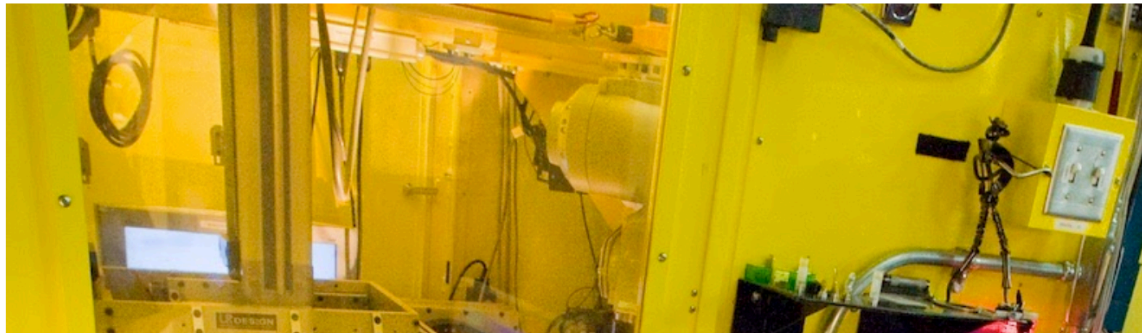

ALS Beamline 4.2.2



Advanced Biofuels and Bioproducts Process Development Unit

DEI UPDATE

Berkeley Lab: DEI Update

 **IDEA** INCLUSION DIVERSITY
EQUITY ACCOUNTABILITY

Stay Safe: Air Quality



QUESTIONS?
THANK YOU